

An aerial photograph of a coastal area. At the top, waves are breaking onto a sandy beach. Below the beach, there's a curved concrete structure, possibly a walkway or part of a building. To the left, a blue-paved path or track runs diagonally. In the foreground, there's a large, curved asphalt parking lot with yellow and blue markings. A white car is parked in the lot. The area is surrounded by green trees and shrubs. The text "Sunset Station Improvements" is overlaid in white, centered in the middle of the image.

Sunset Station Improvements

Project Update

6/6/2023

Brian Majka, Restoration Ecologist, GEI Consultants

Sara Kirk, SRP Design Studio

Background

- Infrastructure at Sunset Station was damaged during 2019-2020 high water
- In 2021, GEI, SRP, and Arcadia Township worked with the community to develop design concepts for repair and improvements
- Open houses were held in Fall, 2021









Design Charette Summary

- Priorities to the community were:
 - ADA accessible beach access
 - Protection of natural dunes
 - Family friendly with elements for all ages
 - Maintain natural aesthetic as much as possible
 - Consider maintenance and longevity, with the understanding that the dunes and Lake Michigan are highly dynamic



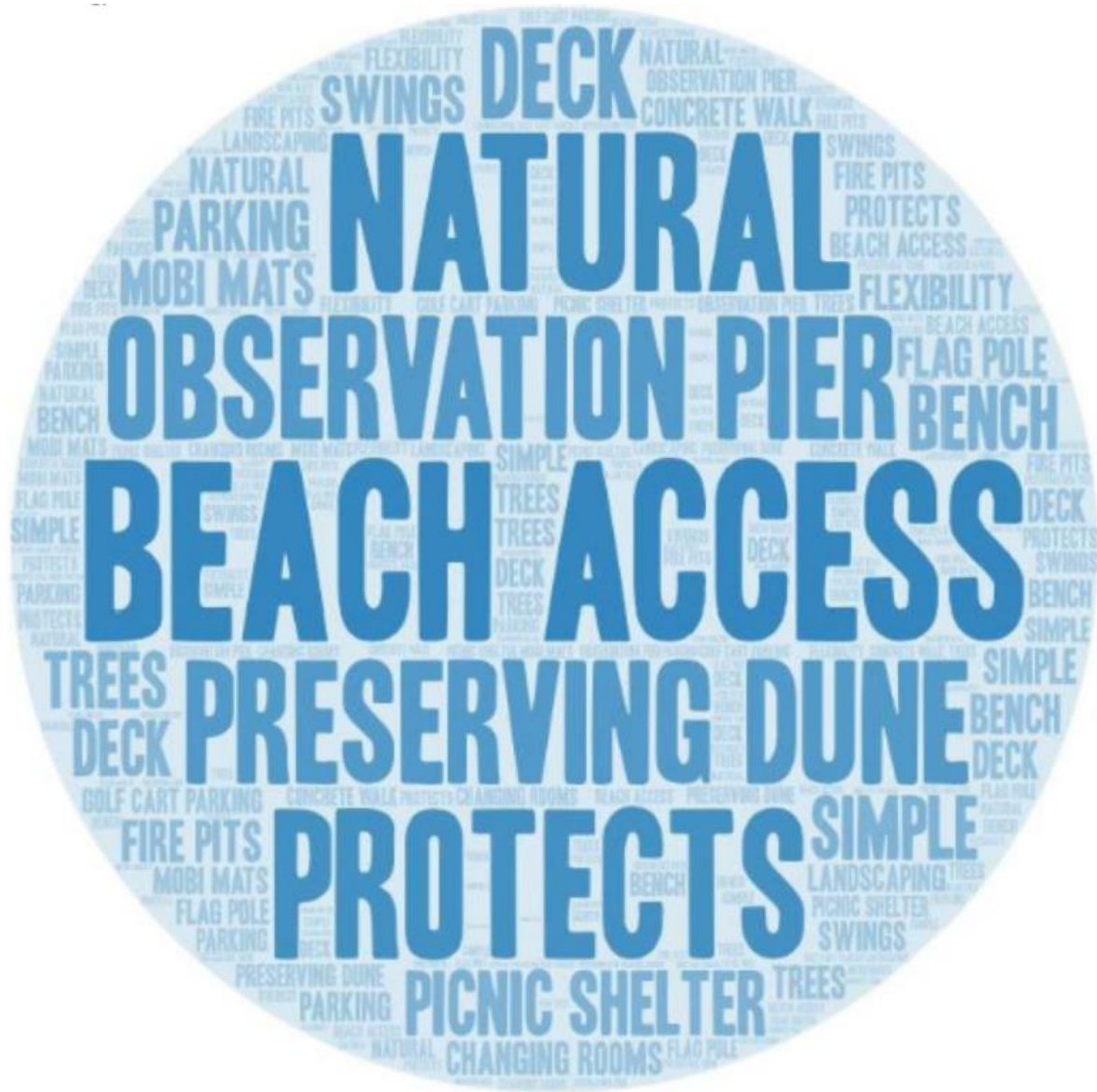



LAKE MICHIGAN

PILE SUPPORTED OBSERVATION DECK, 15 FT WIDE, WITH LARGE BENCH (INTERPRETIVE SIGN OPPORTUNITIES)

SHEET PILE SEAWALL, APPROXIMATE LOCATION

STAIR ACCESS TO BEACH, TO SHEET PILE WALL

SHEET PILE SEAWALL, TURN BACK TO MEET GRADE

SWINGING BENCH ON BOARDWALK FOR ACCESSIBLE ACCESS (3)

MOBI-MAT SYSTEM AT END AS NEEDED (MAY NOT NEED SOME YEARS)

DUNE RESTORATION & PLANTINGS

PROPOSED SHADE TREE

ACCESSIBLE WOOD BOARDWALK, TRANSITION DECK TO ANCHOR MOBI-MAT SYSTEM AS NEEDED

SWINGING BENCH IN SAND (3)

MOBI-MAT SYSTEM BEYOND SHEET PILE WALL, POTENTIAL TO POSITION AS NEEDED FOR CONDITIONS

DUNE RESTORATION & PLANTINGS

COMMUNITY DECK AND BENCHES

FLAG POLE IN PLANTER

PARKING ISLANDS TO BE RECESSED, OPPORTUNITY FOR GREEN INFRASTRUCTURE (RAIN GARDENS)

PARKING, SIMILAR TO PARKING (APPROX 45)

LAKE STREET R.O.W.

BENCHES

PICNIC TABLE

ACCESSIBLE PARKING (4)

FOOT WASHING STATION

GOLF CART PARKING

TRASH/RECYCLE BINS

EX. UTIL. POLE

EX. SWINGS

EX. SLIDE

BIKE PARKING

EX.

RESTORATION PLANTING, TREE REPLACEMENTS

SMALL PICNIC SHELTER, 1 PICNIC TABLE AND 1 GRILL PER SHELTER, FIRST SHELTER TO BE ACCESSIBLE, REUSE ACCESSIBLE PICNIC TABLE

BENCHES WITH OPPORTUNITY FOR INTERPRETIVE SIGNS

ADDITIONAL PLAY EQUIPMENT SPACE (TBD)

ACCESSIBLE SURFACING, OPPORTUNITY TO REINSTALL SWING AND 2-3 ADDITIONAL ACCESSIBLE PLAY STRUCTURES

Funding and Progress

- In Fall, 2021 Arcadia Township applied for design funding from the Michigan Department of Environment, Great Lakes, and Energy (EGLE) Coastal Grant Management Program
- EGLE came out with a one-time grant (High Water Grant) for coastal communities, announced 9/28/22 and due 11/30/22. The project was for planning and/or construction or projects to repair or prevent high water damage
- Due to the unique situation and low match requirements, the township decided to aggressively advance the design development to meet the deadline
- Concepts exactly mirrored those in the original concepts
- Grant application was submitted on 11/29/22, and no award announcements have been made. Anticipation is that awards will be made in mid-late 2023
- The township has held off on additional work and incurring expenses until grants are awarded. Given the delay, the township wanted to take this opportunity to review the plans with the public again.



ARCADIA TOWNSHIP SUNSET STATION PARK REVITALIZATION AND DUNE RESTORATION

60% ENGINEERED DESIGN
NOVEMBER 30, 2022



MANISTEE COUNTY

MICHIGAN STATE MAP
(NOT TO SCALE)



APPROX. PROJECT AREA

SOURCE:
GOOGLE EARTH

PROJECT AREA
(NOT TO SCALE)

SHEET INDEX

SHEET NO.	DRAWING NO.	TITLE
1	G-01	COVER SHEET
2	C-01	EXISTING CONDITIONS
3	C-02	EXISTING CONDITIONS SECTIONS
4	C-03	DEMOLITION PLAN
5	C-04	PROPOSED CONDITIONS
6	C-05	PROPOSED CONDITIONS SECTIONS
7	C-06	PROPOSED CONDITIONS SECTIONS
8	C-07	RESTORATION PLAN
9	D-01	DETAILS

PREPARED FOR:

TOWNSHIP OF ARCADIA
PO BOX 318
ARCADIA, MI 49613
(231) 590-9408

PREPARED BY:

GEI CONSULTANTS OF MICHIGAN, P.C.
5225 EDGEWATER DRIVE
ALLENDALE, MI 49401
(616)384-2710



PROGRESS 60%

				<i>DRAFT</i>	DWG. NO. G-01
					SHEET NO. 1
2	11/30/2022	60% DESIGN			
1	11/18/2022	60% DESIGN DRAFT			
NO.	DATE	ISSUE/REVISION	APP		

GEI PROJECT NO. 2203894

THIS DOCUMENT, AND THE IDEAS AND DESIGNS INCORPORATED HEREIN, IS AN INSTRUMENT OF PROFESSIONAL SERVICE, IS THE PROPERTY OF GEI CONSULTANTS AND IS NOT TO BE USED, IN WHOLE OR IN PART, FOR ANY OTHER PROJECT WITHOUT THE WRITTEN AUTHORIZATION OF GEI CONSULTANTS.

NOV 15 2022 11:11 AM C:\Users\jgarcia\OneDrive\Documents\ArcGIS\Projects\Sunset Station Park Revitalization and Dune Restoration\Map_Series\G-01_Cover_Sheet.dwg - 11/18/2022

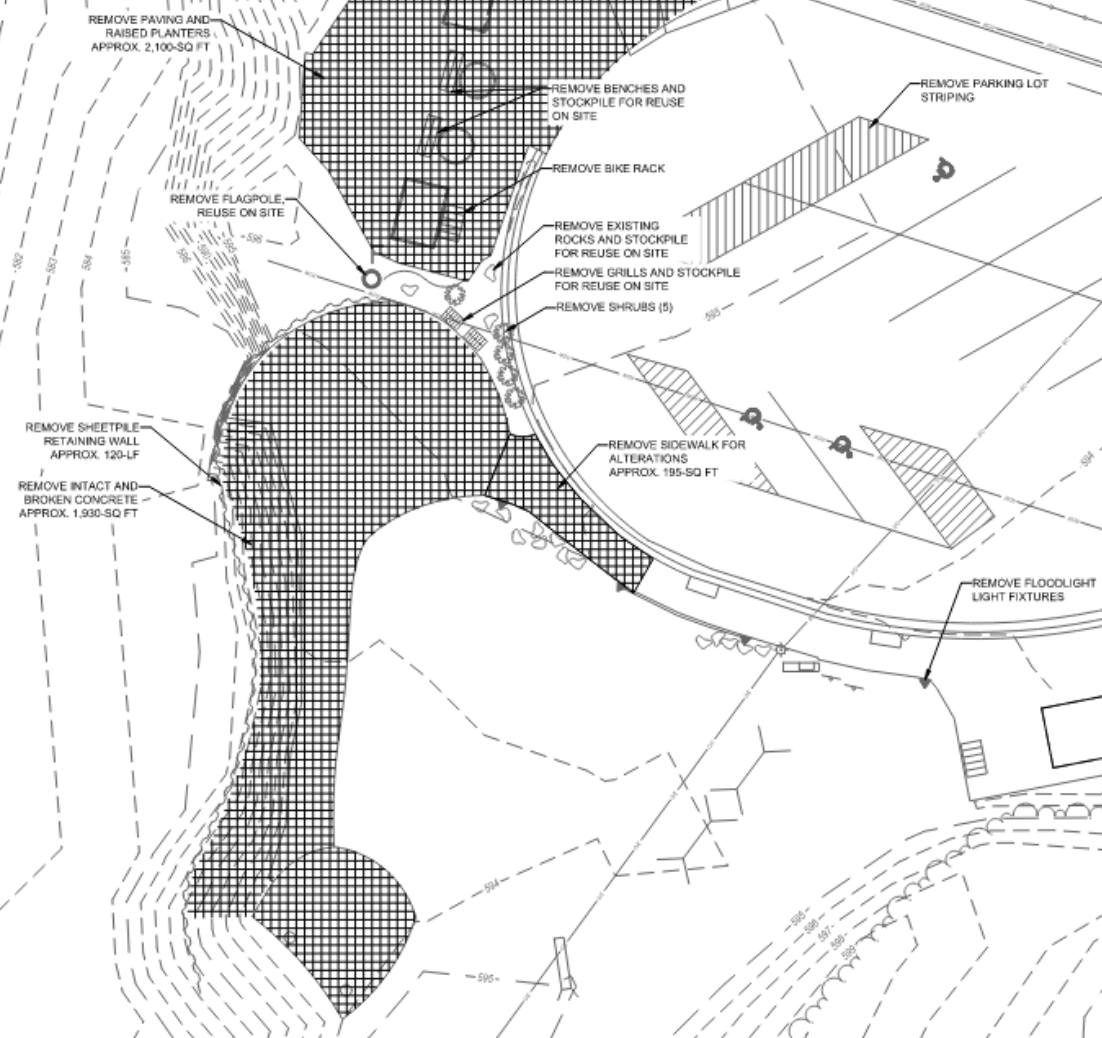
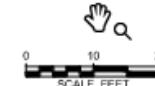

QUANTITY TABLES

PAVING	
CONCRETE PAVING	2,125 SF
ASPHALT PAVING	2,100 SF

SHEETPILE WALL	
SHEETPILE WALL	120 LF

LEGEND

	EX. MAJOR CONTOUR
	EX. MINOR CONTOUR
	EDGE OF WATER
	TREELINE
	EX. FENCE
	EX. RIGHT OF WAY
	EX. OVER-HEAD UTILITIES
	EX. SHEETPILE WALL
	SIGN
	ROCK

	UTILITY POLE AND GUY WIRE
	UTILITY AND LIGHT POLE
	TELEPHONE RISER
	FLOODLIGHT
	BIKE RACK
	BBO GRILL
	PARK BENCH
	ACCESSIBLE PARKING
	DECIDUOUS TREE
	DECIDUOUS SHRUB

PROGRESS 60%

NOTES:
SURVEY CONDUCTED BY ROWE PROFESSIONAL SERVICES COMPANY
HORIZONTAL DATUM: MICHIGAN STATE PLANE COORDINATE SYSTEM, CENTRAL ZONE, NAD83
VERTICAL DATUM: NAVD83

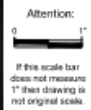

DRAFT

Designed: #####
Drawn: AT
Checked: #####
Approved: #####
P.E. No: ###
GEI Project: 2203894



TOWNSHIP OF
ARCADIA
PO BOX 318
ARCADIA, MI 49613

**SUNSET STATION PARK
REVITALIZATION AND
DUNE RESTORATION**

ARCADIA SUNSET STATION
LAKE STREET
ARCADIA, MI 49613

NO	DATE	ISSUE/REVISION	APP
2	11/30/2022	60% DESIGN	
1	11/18/2022	60% DESIGN DRAFT	

SHEET NAME
DEMOLITION PLAN

DWG NO.
C-03

SHEET NO.
4

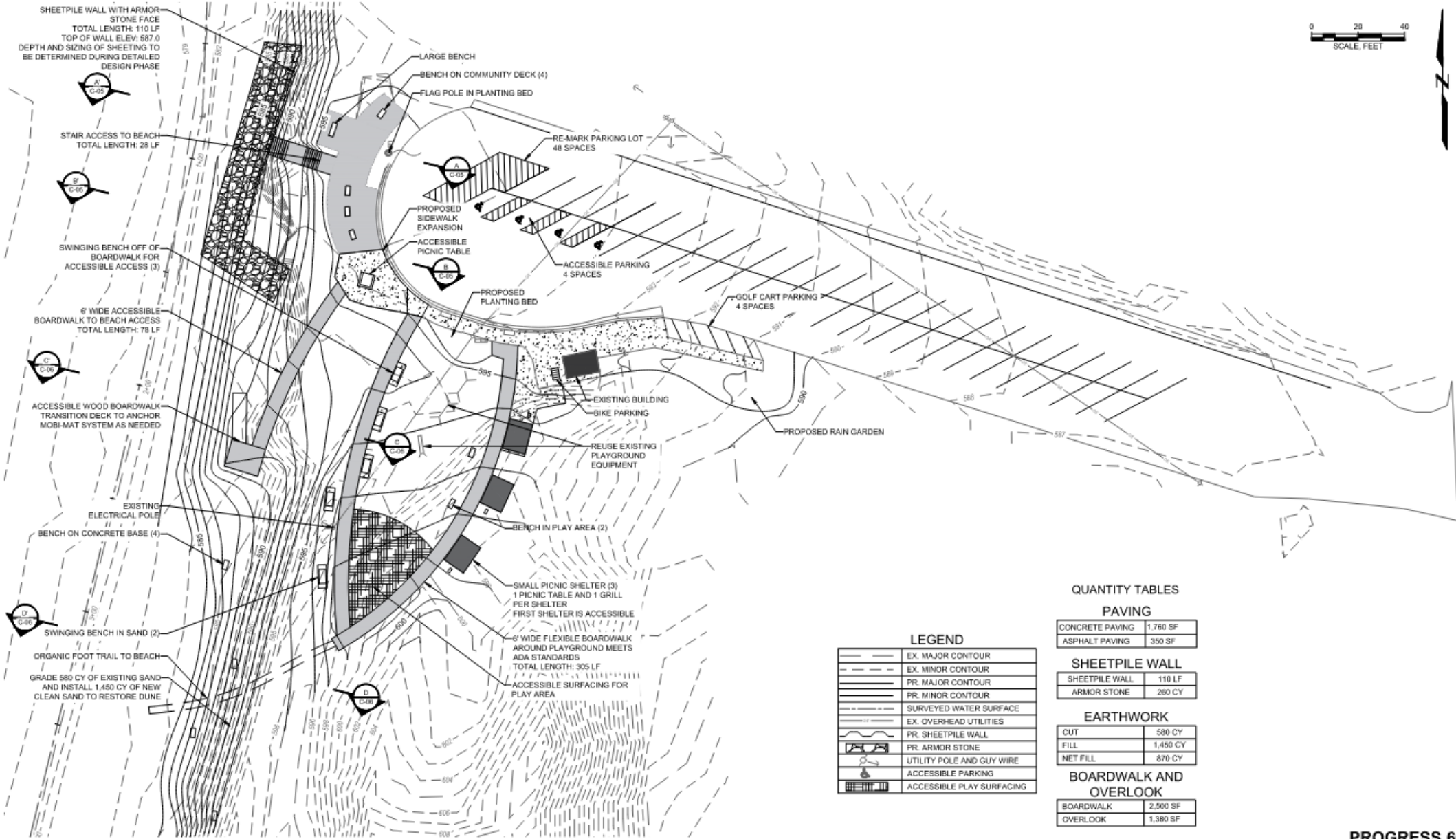

PROGRESS 60%

NOTES:
 SURVEY CONDUCTED BY ROWE PROFESSIONAL SERVICES COMPANY
 HORIZONTAL DATUM: MICHIGAN STATE PLANE COORDINATE SYSTEM, CENTRAL ZONE, NAD83
 VERTICAL DATUM: NAVD88

Attention:
 If this scale bar does not measure 1" then drawing is not original scale.

DRAFT

Designed: *****
 Drawn: AT
 Checked: *****
 Approved: *****
 P.E. No: ***
 GEI Project 2203894



TOWNSHIP OF
 ARCADIA
 PO BOX 318
 ARCADIA, MI 49613

**SUNSET STATION PARK
 REVITALIZATION AND
 DUNE RESTORATION**
 ARCADIA SUNSET STATION
 LAKE STREET
 ARCADIA, MI 49613

NO	DATE	ISSUE/REVISION	APP
2	11/30/2022	60% DESIGN	
1	11/18/2022	60% DESIGN DRAFT	

SHEET NAME	DWG NO.
PROPOSED CONDITIONS	C-04
SHEET NO.	5

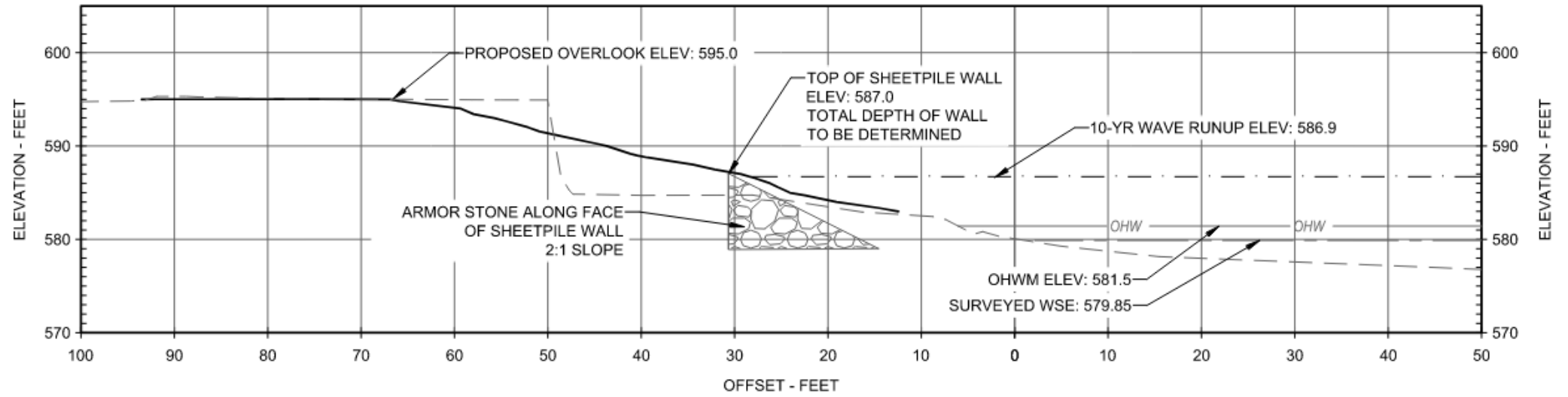

C-04 SECTION B-B'
STA: 1+22



LEGEND

---	EXISTING CONDITIONS
—	PROPOSED CONDITIONS

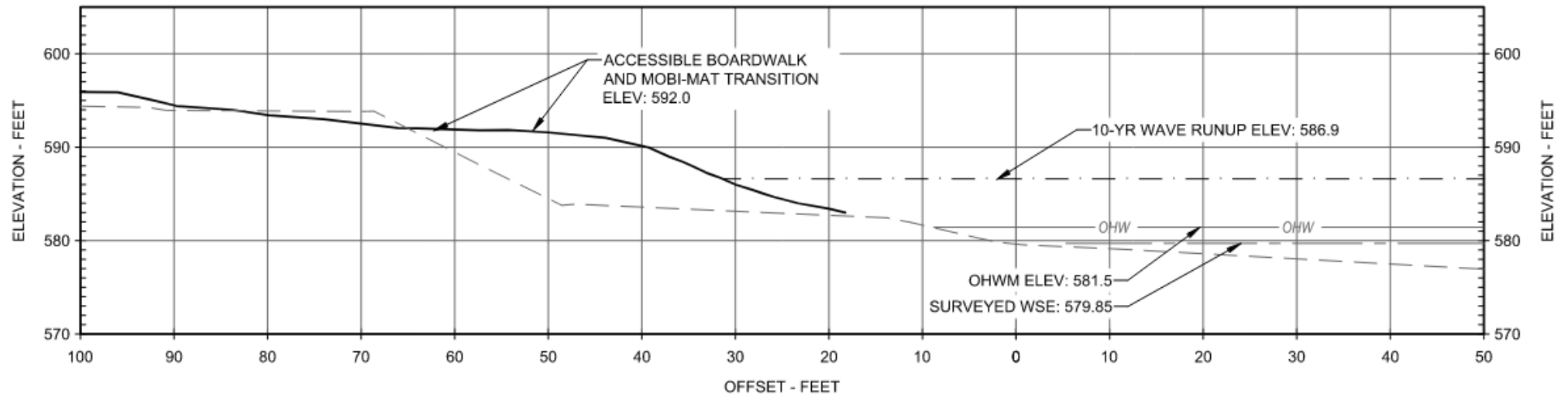

C-04 SECTION C-C'
STA: 2+00

Next Steps

- Solicit input one more time
- Finalize design details
- Apply for permits
- Continue to seek construction funds



Questions?



Brian Majka
GEI Consultants, Inc
bmajka@geiconsultants.com