

The South Course at Arcadia Bluffs

Michigan

Arcadia

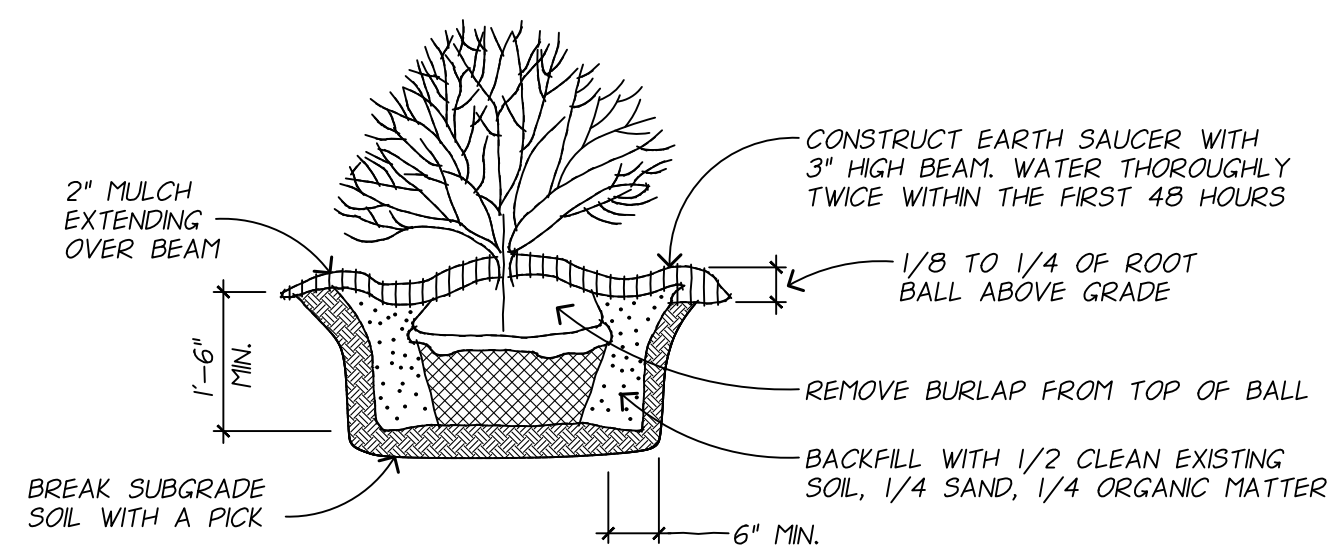

3 TYPICAL SHRUB PLANTING DETAIL
L.I.O. NO SCALE

AT PLANTING PRUNE ONLY CROSSING LIMBS, CO-DOMINANT LEADERS, BROKEN OR DEAD BRANCHES AND ANY BRANCHES THAT POSE A HAZARD TO PEDESTRIANS

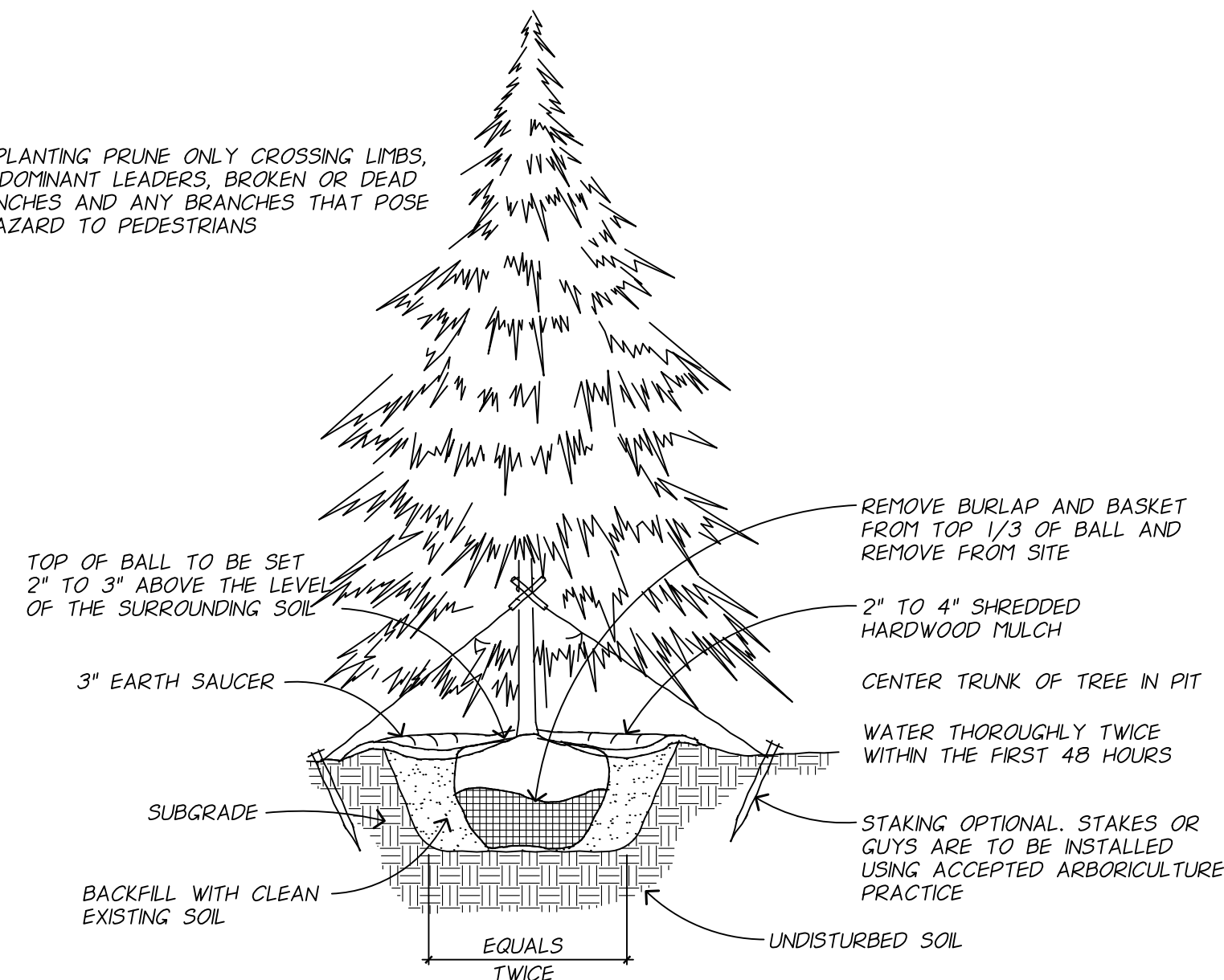

2 TYPICAL TREE PLANTING DETAIL
L.I.O. NO SCALE

AT PLANTING PRUNE ONLY CROSSING LIMBS, CO-DOMINANT LEADERS, BROKEN OR DEAD BRANCHES AND ANY BRANCHES THAT POSE A HAZARD TO PEDESTRIANS

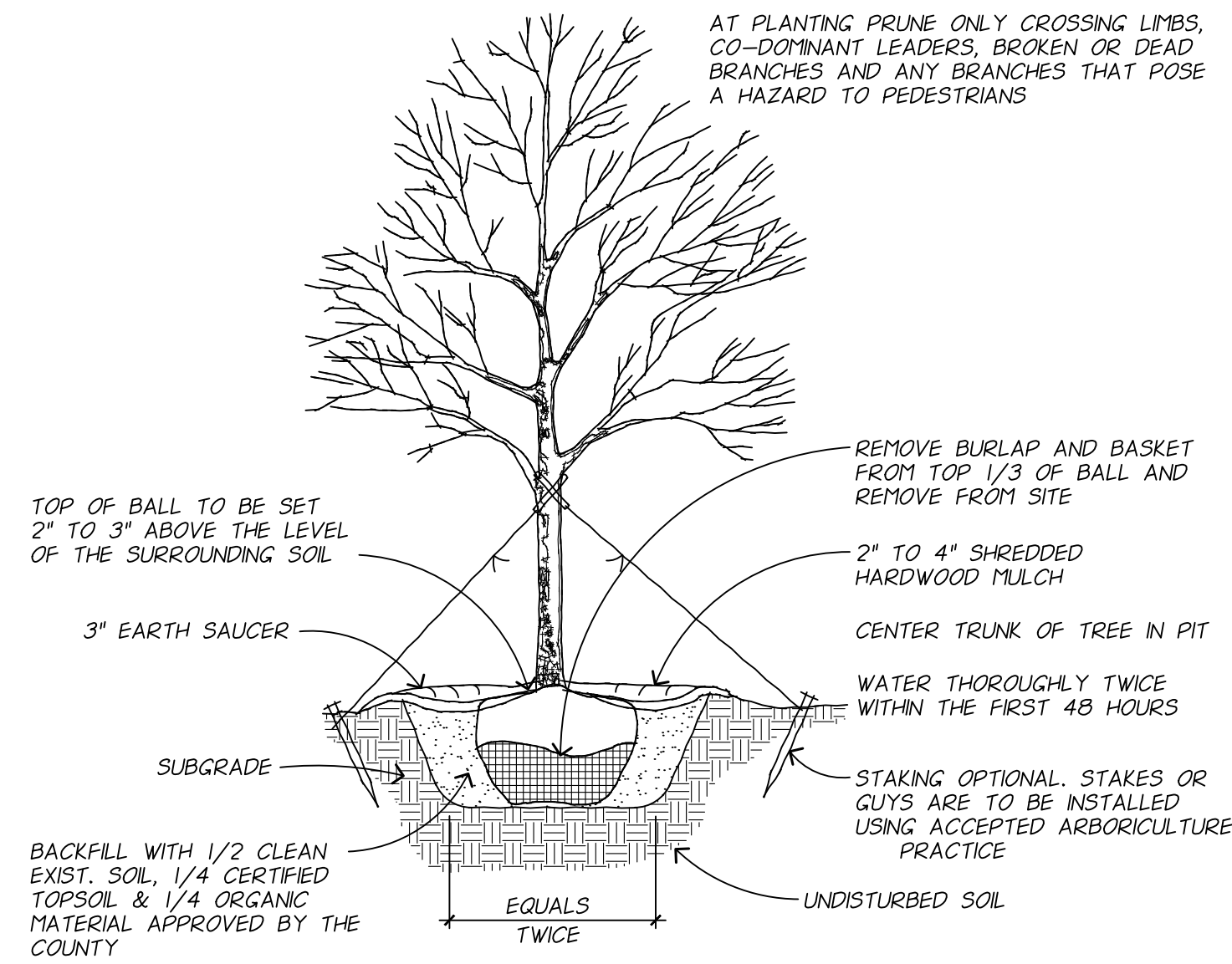

1 TYPICAL TREE PLANTING DETAIL
L.I.O. NO SCALE

PLANT MATERIAL SCHEDULE					
MARK	QTY	COMMON NAME	SIZE	IRRIGATION	DETAIL
DT-1	2	RIVER OR WHITE BIRCH	2" CAL. MIN.	YES	1/L.I.O.
DT-2	25	FLOWERING CHERRY	2" CAL. MIN.	YES	1/L.I.O.
ET-1	30	BLACK HILLS SPRUCE	6"-0"	YES	2/L.I.O.
SH-1	38	JUNIPER OR SIMILAR EVERGREEN SHRUB	24"-30"	YES	3/L.I.O.
SH-2	10	HYDRANGEA OR SIMILAR FLOWERING SHRUB	24"-30"	YES	3/L.I.O.

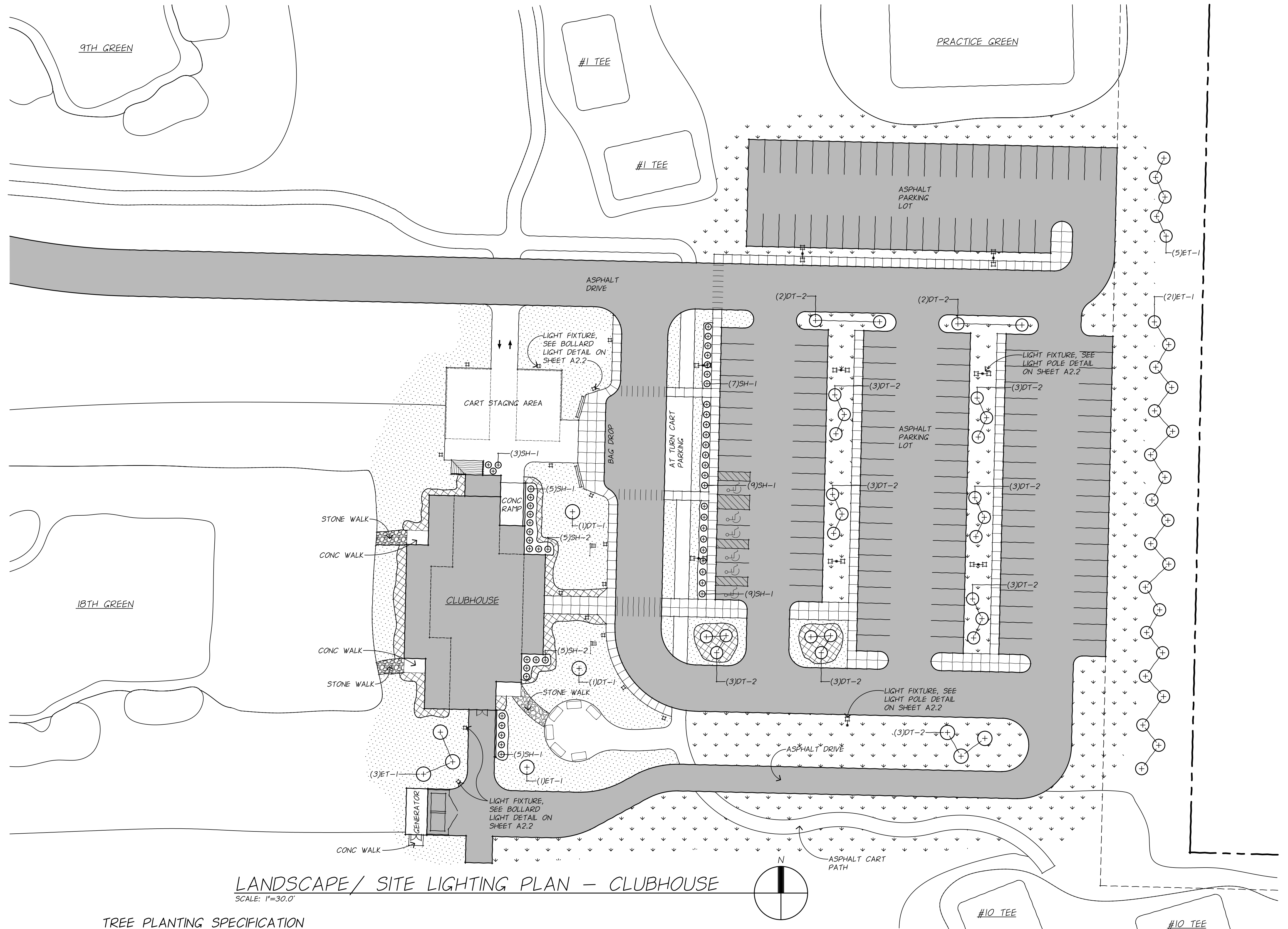

LANDSCAPE/SITE LIGHTING PLAN - CLUBHOUSE
SCALE: 1"=30.0'

TREE PLANTING SPECIFICATION

- NOTE: ALL PLANT MATERIAL SHALL COMPLY WITH THE AMERICAN STANDARD FOR NURSERY STOCK ANSI Z60.1. ALL PLANT MATERIAL HAS BEEN SELECTED BASED ON SITE CONDITIONS AND CONSTRAINTS.
- PLANTING BALLED AND BURLAPPED TREES.
 - IF NOT READILY APPARENT, LOCATE ROOT FLARE BY REMOVING TWINE, BURLAP AND EXCESS SOIL.
 - DIG TREE HOLE AT LEAST TWO TIMES WIDER THAN THE TREE BALL, WITH SIDES SLOPED TO AN UNEXCAVATED OR FIRM BASE. DIG HOLE TO A DEPTH SO THE LOCATED ROOT FLARE, AT THE FIRST ORDER LATERAL ROOT, WILL BE AT FINISHED GRADE.
 - LIFTING ONLY FROM THE BOTTOM OF THE ROOT BALL, POSITION TREE ON FIRM PAD SO THAT IT IS STRAIGHT AND TOP OF ROOT FLARE IS LEVEL WITH THE SURROUNDING SOIL.
 - REMOVE ALL TWINE FROM THE ROOT BALL. IF PRESENT, REMOVE AND DISCARD AT LEAST THE TOP ONE HALF OF THE WIRE BASKET. BURLAP SHALL BE REMOVED FROM THE TOP TO A POINT HALF WAY DOWN THE ROOT BALL AND DISCARDED.
 - WITH CLEAN, SHARP PRUNING TOOLS, PRUNE OFF ANY SECONDARY/ ADVENTITIOUS, GIRDLING AND POTENTIAL GIRDLING ROOTS.
 - BACKFILL PLANTING HOLE WITH EXISTING UNAMENDED SOIL AND THOROUGHLY WATER.
 - MULCH THE ENTIRE PLANTING SURFACE WITH COMPOSTED BARK APPLIED NO LESS THAN TWO INCHES (2") DEEP AND NO MORE THAN THREE INCHES (3") DEEP, LEAVING THREE INCHES (3") ADJACENT TO THE TREE TRUNK FREE OF MULCH.

GRASS AND FLOWER BED LEGEND

- INDICATES AREAS OF BLUEGRASS SOD LAWN ON 4"-6" TOPSOIL WITH IRRIGATION
- INDICATES AREAS OF FESCUE GRASS OR SIMILAR. FINAL GRASS SELECTION BY GOLF COURSE ARCHITECT. DESIGN INTENT IS A NATURAL FEEL COMPATIBLE WITH THE GOLF COURSE. OUTER EDGE LIMIT TO BE FIELD DETERMINED BY GOLF COURSE ARCHITECT.
- PERENNIAL AND ANNUAL FLOWER BED

SUP/See Plan Approval
12-14-16 date

1616 commission

L.I.O. sheet

This drawing is the sole property of Oppenhuizen Architects and is not to be used or reproduced without their written consent. ©

333 Jackson St.
Grand Haven
Michigan
49417

ph 616 846 8990
fax 616 846 8898

OppenhuizenArchitects

Mark A. Oppenhuizen AIA